

DETAIL 10.2: SECTION A SCALE 1:20

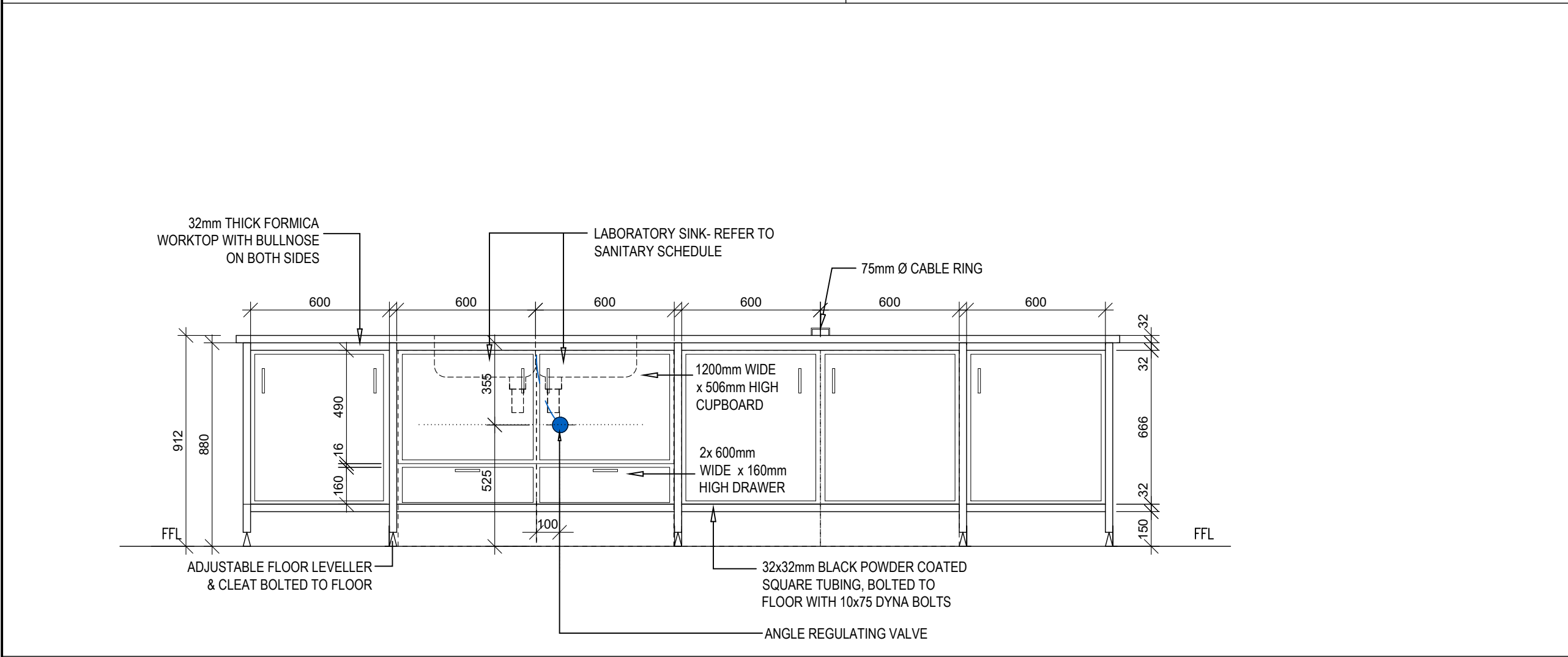

DETAIL 10.3: ADJUSTABLE FLOOR LEVELER SCALE 1:2

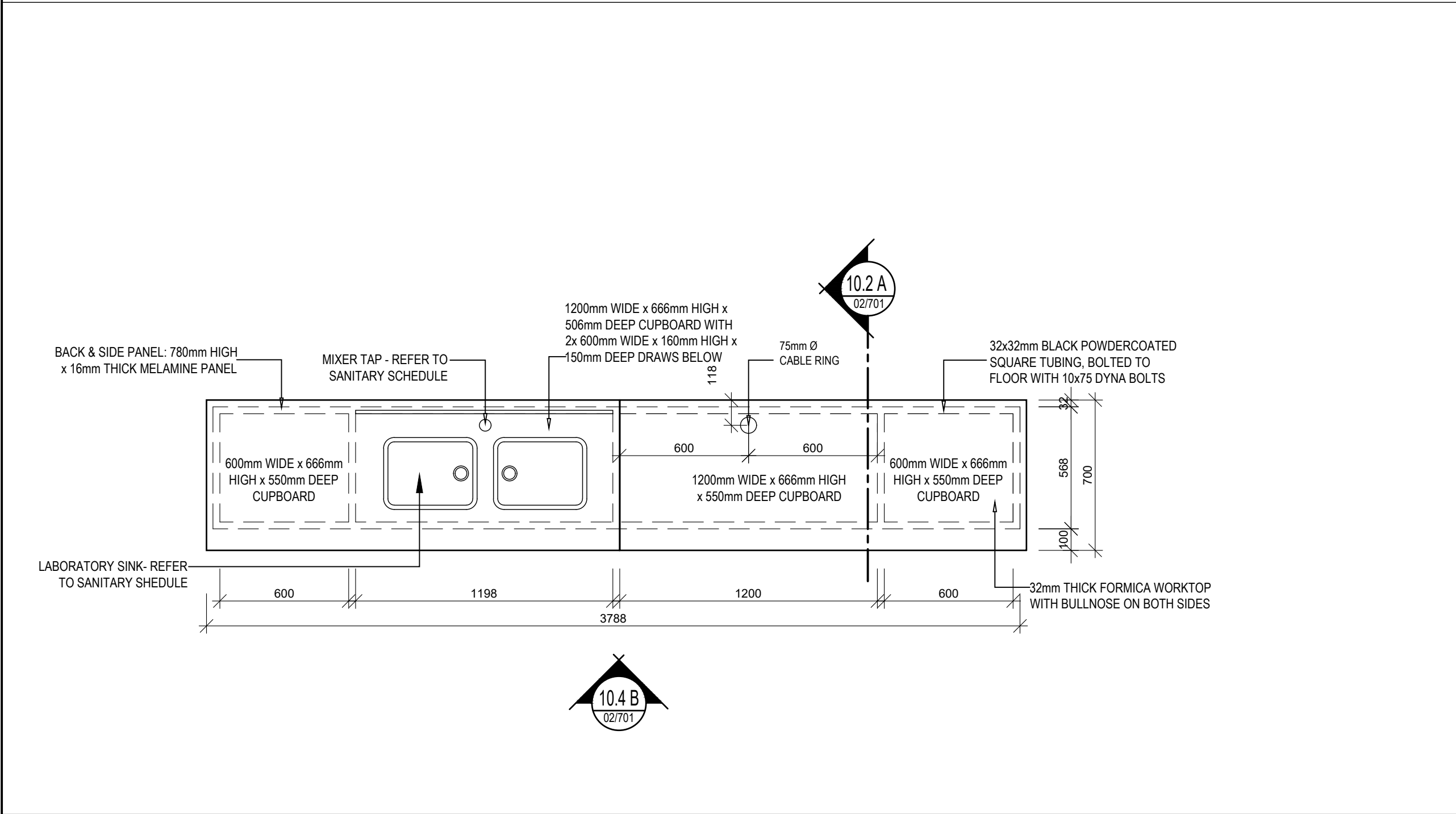

DETAIL 10.4: ELEVATION B SCALE 1:20

SCIENCE LAB - TEACHER'S DESK

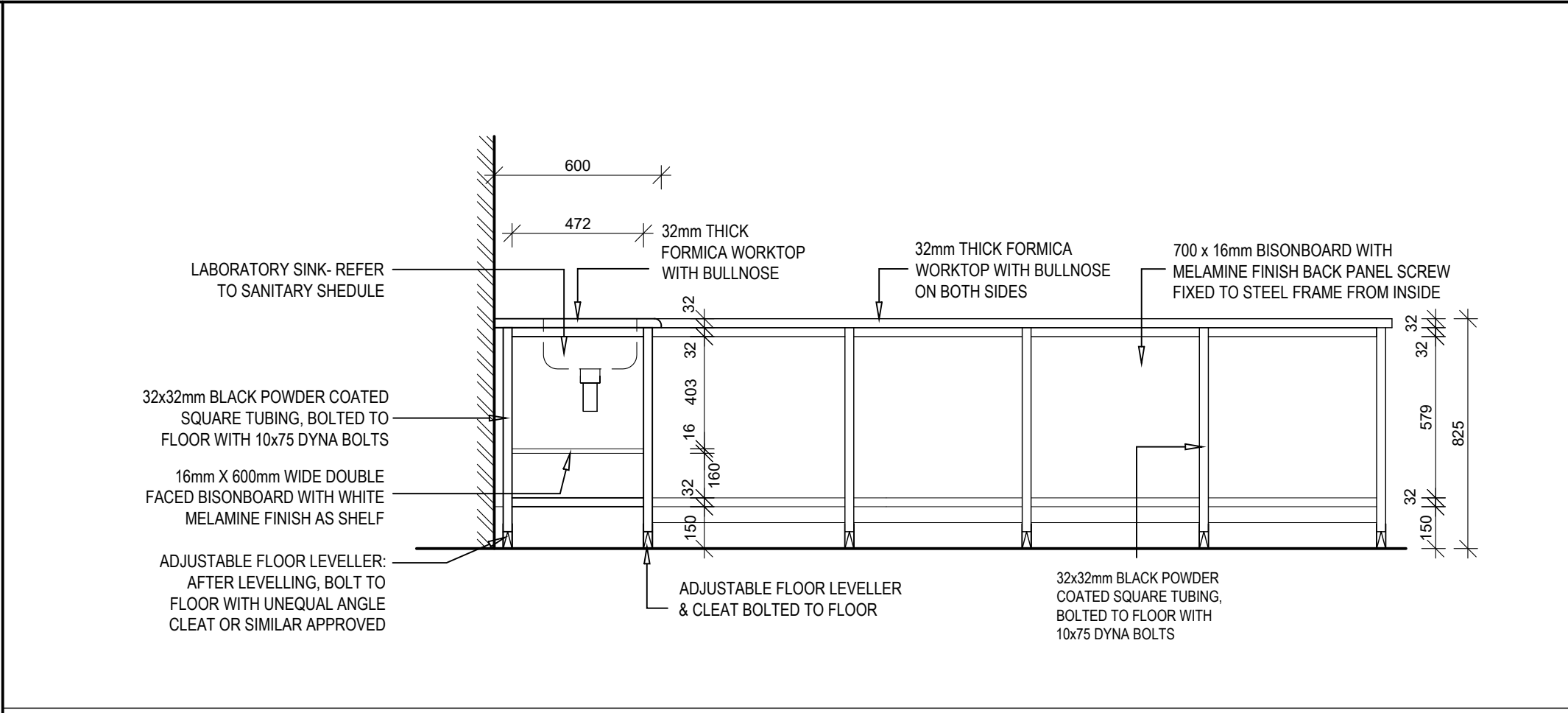

DETAIL 11.2: SECTION A SCALE 1:20

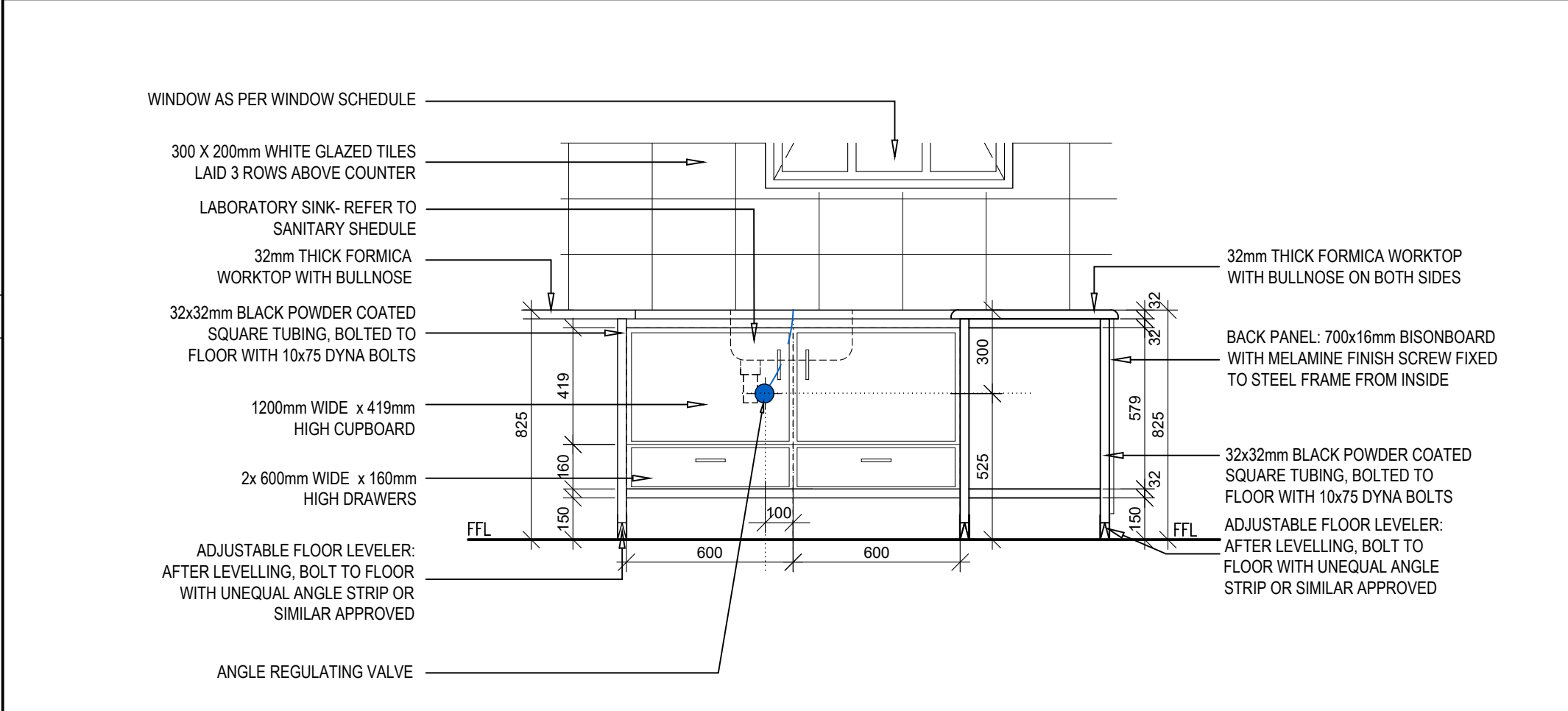

DETAIL 11.3: SECTION B SCALE 1:20

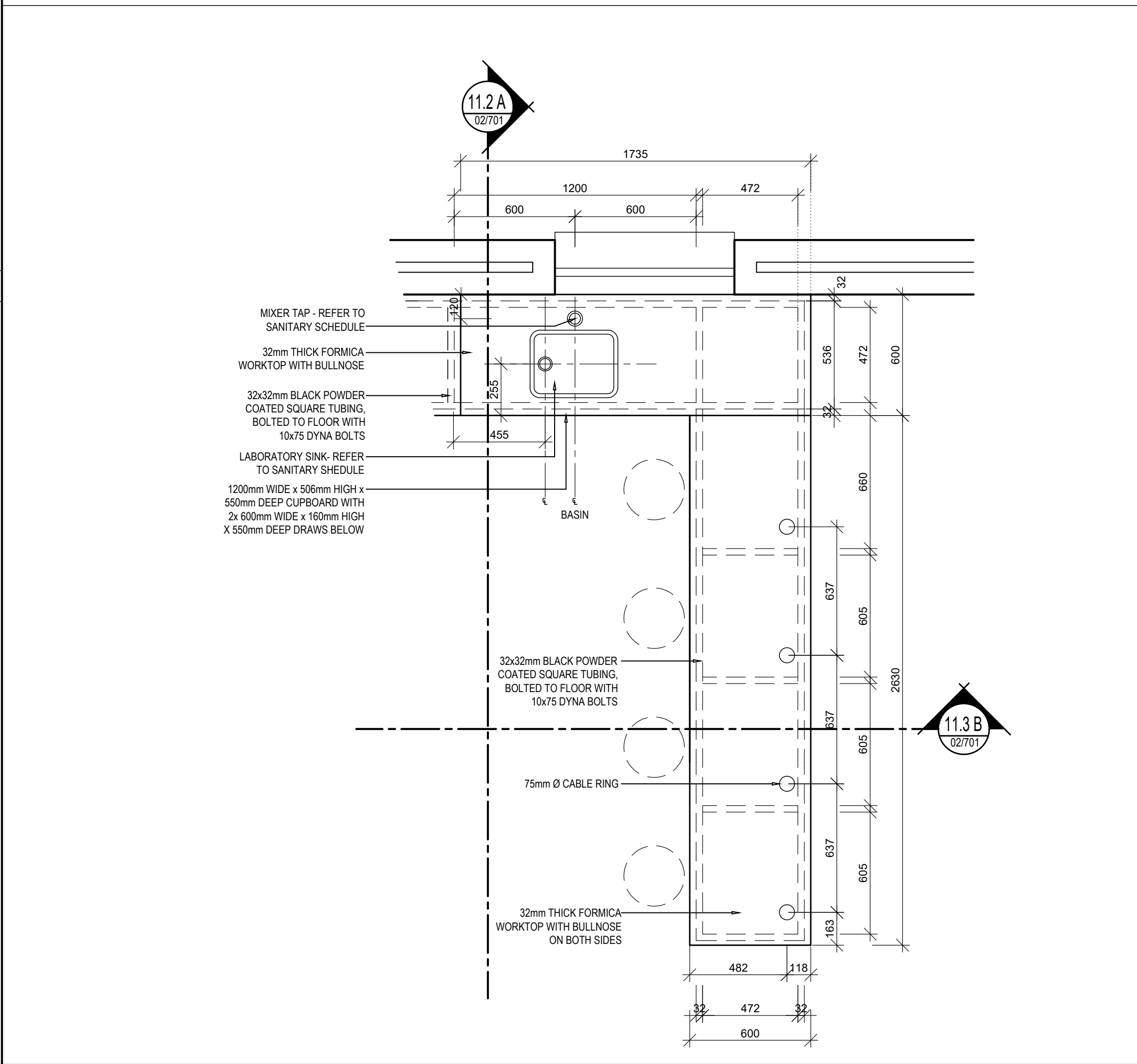

DETAIL 11.1: STUDENT WORK SPACE FLOOR PLAN SCALE 1:20

SCIENCE LAB - STUDENT WORK SPACE

GENERAL SPECIFICATIONS:

CHEMICAL STORE:

IRONMONGERY NOTE:
CUPBOARD DOOR HINGES - TO BE FGV
CLICK-ON 110° 15mm CRANK HINGE TO BE
SCREW FIXED (PRODUCT CODE
51NKSX55100 AS PER "ROCO" CATALOGUE
10). 1xPAIR PER DOOR
DOORS & DRAWER HANDLES - TO BE 16mm
LONG ALUMINUM D HANDLE (PRODUCT
CODE RAH42 AS PER "ROCO" CATALOGUE
10). 1x HANDLE PER DOOR/DRAWER
DOOR LOCKS - TO BE 19x22mm MORTICE
LOCK (PRODUCT CODE VLC1736 - NICKEL).

CUPBOARD SPEC NOTE:

CUPBOARD CARCASSES TO BE 16mm
DOUBLE FACED BISONBOARD WITH WHITE
MELAMINE FINISH
CUPBOARD DOORS TO BE 16mm DOUBLE
FACED BISONBOARD WITH WHITE
MELAMINE FINISH, SQUARE EDGED WITH
5mm WHITE PVC EDGINGS ALL ROUND

COUNTER TOPS TO BE 32mm THICK
FORMICA WORK TOPS
COUNTER TOPS TO HAVE 50mm HIGH
FORMICA SKIRTINGS

LABORATORY:

COUNTER TOPS TO BE 32mm THICK
FORMICA WORK TOPS

LABORATORY TAP FOR WORKTOPS:
REFER TO SANITARY AND FURNITURE
SCHEDULE.

LABORATORY SINK: REFER TO SANITARY
AND FURNITURE SCHEDULE.

EQUIPMENT STORE:

ALL SALIGNA BOARDS TO BE SLIGHTLY
ROUNDED, THOROUGHLY SANDED AND
VARNISHED WITH CLEAR FLASCON VARNISH

WORKSHOP DRAWINGS TO BE SUBMITTED
TO ARCHITECT BEFORE ANY WORK
COMMENCES.

ISSUED FOR APPROVAL

KEY

PSP

ARCHITECT

13 Cumberland Street, Mithatha
P.O. Box 7105
Mithatha, 5100
Tel: 047 532 5382
Fax: 086-648-2131

18 Lower Goldenhuys Drive,
Emmarentia, Johannesburg
P.O. Box 51924
Auckland Park, 2006
Tel: 011-486-2623
Fax: 086-648-1935
Email: mpande@mpandeni.co.za

ARCHITECTURAL PROFESSIONAL SACAP NUMBERS:

H.L. MANTEL SACAP 3045

IMPLEMENTED BY

INDEPENDENT DEVELOPMENT TRUST

| | | |
|-----------------|------------|--|
| SIGNATURE | DATE | SHEET NO. A1 |
| DESIGNED - | - | SCALE 1:100 |
| DRAWN OM | 08/10/2017 | STATUS LISTING I = INFORMATION FM = FOR MEASURE T = TENDER C = CONSTRUCTION AB = AS BUILT |
| VERIFIED - | - | |
| VALIDATED - | - | |

CLIENT

Province of the
EASTERN CAPE
EDUCATION

IMPLEMENTING AGENT

PROJECT

DOE PORTFOLIO PROGRAMME
ESTABLISHMENT OF NEW SCHOOLS
HILLBROW - SENIOR SECONDARY SCHOOL
PROVINCE: EASTERN CAPE PROVINCE

DRAWING TITLE

SCIENCE LAB (BLOCK S-B & S-Z)
JOINERY DETAILS PART 2 OF 2

DRAWING DESCRIPTION

-

Stand Co-Ordinates:

| | | | |
|------------------|-------------|------------------------|-----------------|
| EMIS NUMBER | DISCIPLINE | DRAWING NUMBER | STATUS/REVISION |
| 200500293 | ARCH | 2204 w07 02/701 | FA AA |